

Take a closer look

Focus Centraflex UV/IR Series

ADVANCED TECHNOLOGY PLATFORM



FOCUS
LABEL MACHINERY LTD

Focus Centraflex UV/IR Series

ADVANCED TECHNOLOGY PLATFORM

Printing in a competitive market today requires high productivity, quality and cost efficient operation. Focus Label Machinery manufactures a wide range of equipment designed to meet specialised applications.

The new Centraflex combines high quality printing with the beauty of a compact Central Impression design that lends itself to many specialised printing & converting for unsupported & synthetic product applications.

This press can be found converting products as diverse as Sachets, Shrink Wraps, Tags, Labels & Meat Casings. Combined with a host of options the Centraflex is one of the leading presses in its class and we are delighted to present a full UV drying system compatible with our entire 250 & 330 range of equipment.

CENTRAFLEX STANDARD FEATURES:

- > New Press design with 5 + 1 or 6 + 1 Colour options
- > Superior Register & Print Quality for unsupported web applications
- > UV & IR Drying Options
- > Chilled central drum
- > Compact converting press.



UV/INFRA-RED DRYING

The Centraflex has the option of UV or IR drying systems. Individual control over each head allows close monitoring of heat management with both water & air cooling features. During press set up or stoppage the system reverts to standby mode to prevent unwanted heat build up.



TURN BAR

For packaging & casings application we provide a Turn bar to allow both sides of the web to be printed simultaneously. This compact solution is simple to operate and provides excellent control of the web.



PRINT STATION

Accurate register & stability is a feature of the Central Impression system, even on the most difficult of Substrates. The press is equipped with quick release 2 Roll Flexographic Cartridges or can be supplied with optional enclosed cartridges & Ink Pumps.



CENTRAL DRUM

The CI Drum provides superb control over unsupported substrates. On the larger equipment the Centraflex has a chill system for total monitoring & control over heat management generated by the drying systems.



WEB GUIDE

A single automatic web guide is provided as standard with combined splice table, a second unit is also available for control over multiple webs.

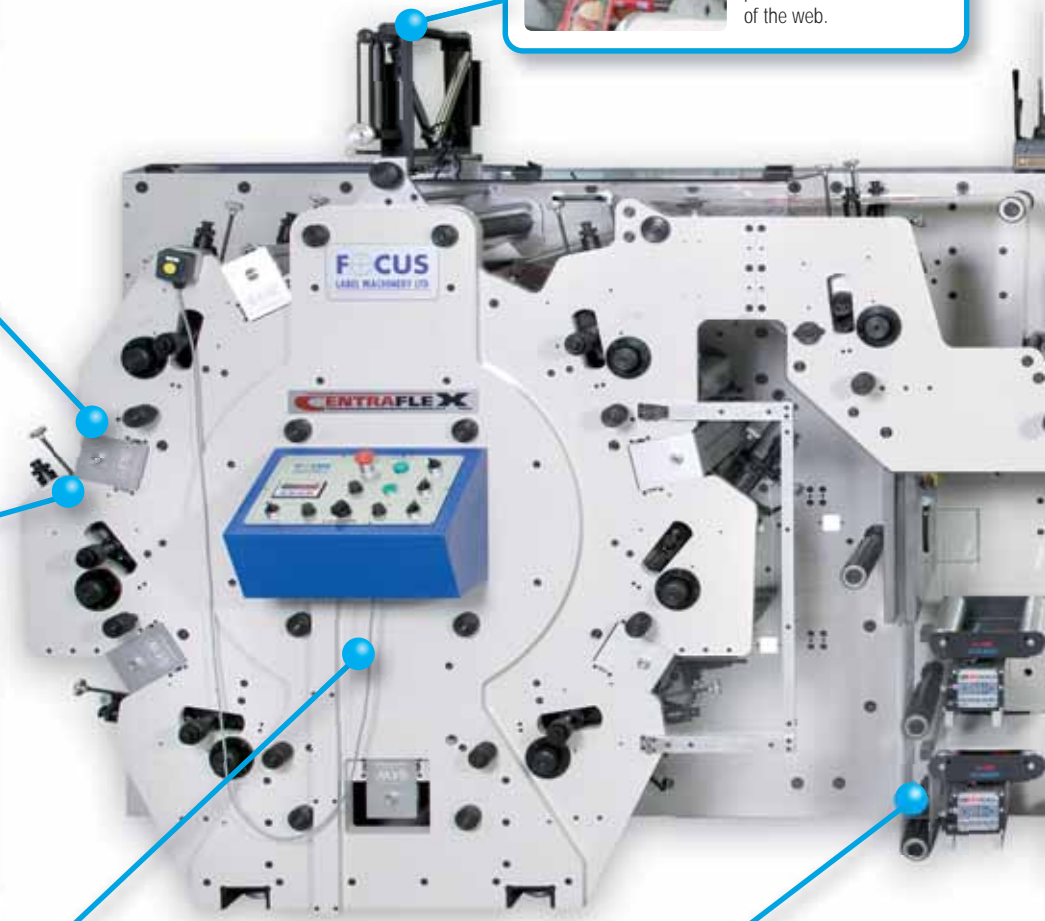



LAMINATION

Various configurations of unwind & rewind turrets can be supplied for over lamination of synthetic films & removal of waste matrix.



INSPECTION SYSTEM

Video inspection systems are available for live monitoring of the web for colour & print quality.



SLITTING

A dedicated Slitting system is provided for trimming or splitting webs. The blades are easy to position & set requiring little maintenance. Perforation blades can also be supplied.



ROTARY DIE STATION

For label, tickets & carton production the Centraflex can be equipped with Rotary Die stations. These heavy-duty units can handle complex cutting & converting requirements.



COLD FOIL

To make the best of the Centraflex platform Focus has designed its own Cold Foil application system for value added printing applications in packaging & labels.

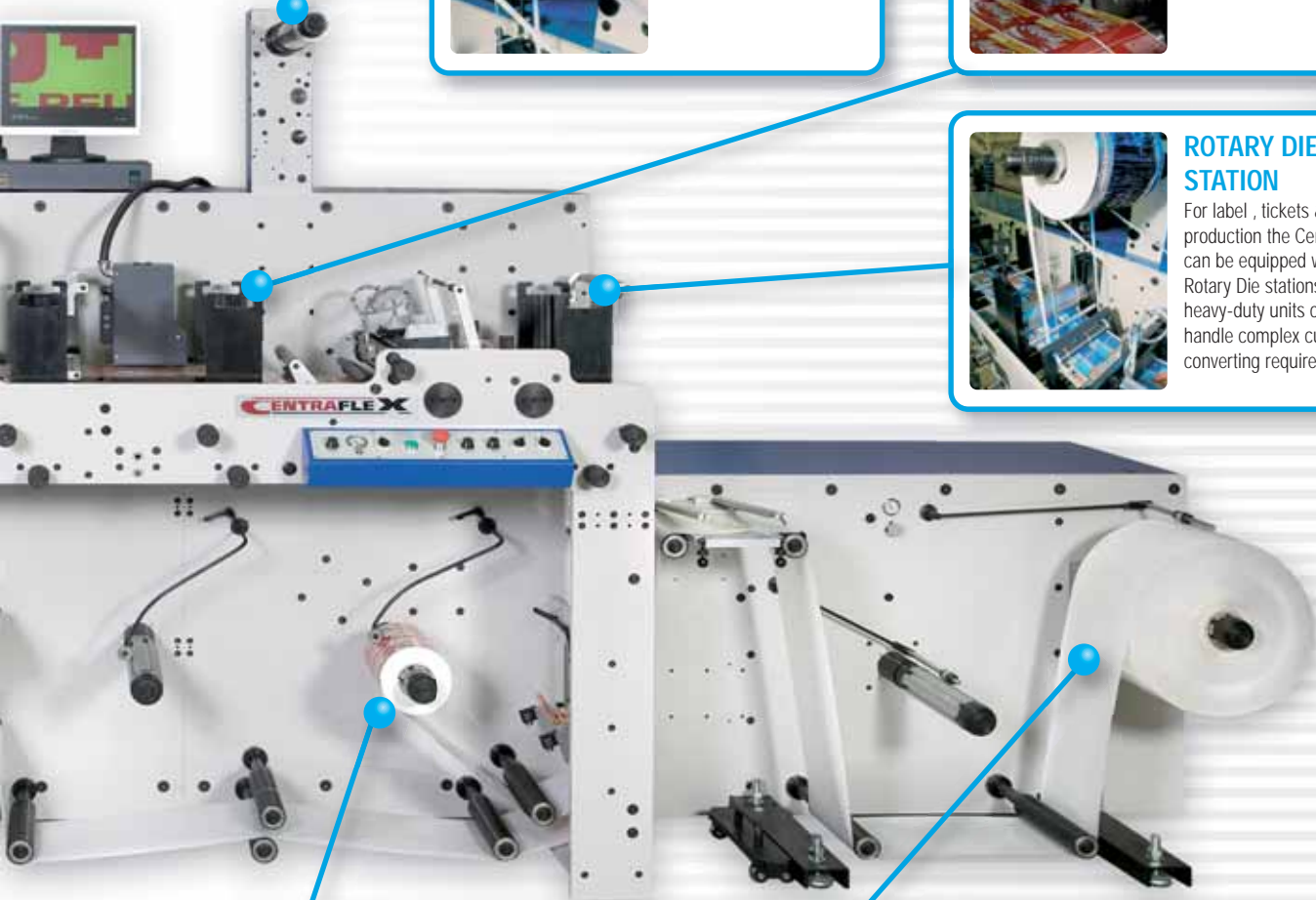

CENTRAFLEX 5+1 PRESS

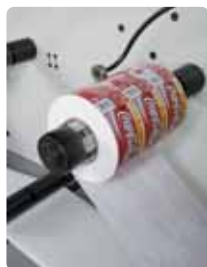

REWIND

Direct Torque motors ensure complete tension control over the most sensitive of substrates. 75mm Air cores are supplied as standard with alternative sizes also available.



UNWIND MODULE

The large capacity unwind module includes automatic tension control as standard. One or two Unwinds can be supplied. The Module also has facilities to accept a web cleaner & corona treater if desired.



WEB CLEANER/ CORONA TREATER

These optional systems will ensure the substrate is in the optimum condition prior to printing & converting.



SHEETER/STACKER

For labels, computer laser sheets, tickets & small cartons the Centraflex can be fitted with a stacking system. The semi automatic system will collect sheets by stacking on the delivery table and can even assist in batch counting for packing.

CENTRAFLEX UV / IR SPECIFICATIONS

| | CENTRAFLEX 250/330 | CENTRAFLEX 250/330 U.V |
|---------------------|--|------------------------|
| Number of Colours | 5 + 1 | 6 + 1 |
| Max Print Width | 10"(254mm)/13"(330mm) | 10"(254mm)/13"(330mm) |
| Print range | 7-20" (188-510mm) | 10"-20" (254mm-510mm) |
| IR Drying | Standard | Optional |
| UV Drying | 1 Optional | Standard |
| Chill Drum | Optional | Standard |
| Rotary Die Cutting | Optional | Optional |
| Rotary Slitting | Optional | Optional |
| Max Unwind Diameter | 650mm (Std) 1000mm(Optional) | 1000mm (Std) |
| Max Rewind Diameter | 600mm(22") | 600mm(22") |
| Other Options | Turn Bar, Cold Foil, Lamination ,Rotary Cutting/Slitting, Sheet Stacker Web Cleaner, Corona Treater, Video Inspection. Double Unwind, Double Rewind, Static control. | |

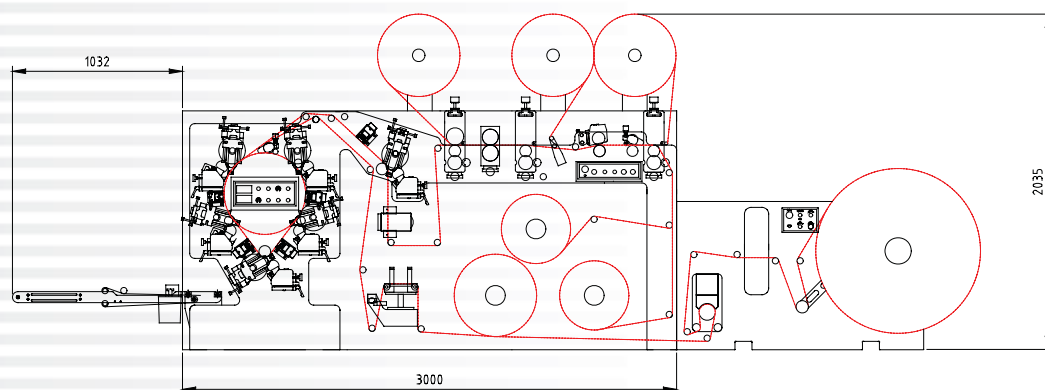

Standard 5+1 Centraflex Press

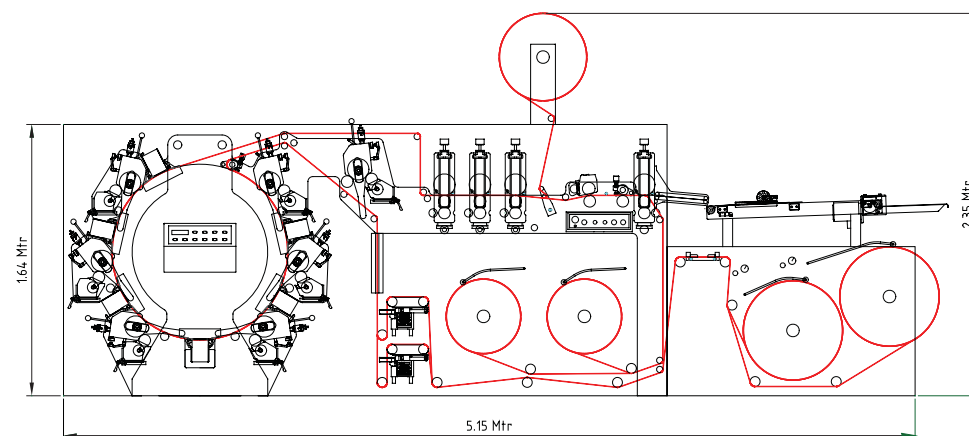

Full UV Water Cooled 6 + 1 Centraflex Press